

BELLE TIRE

TEMPORARY MASONRY WALL BRACING PLAN

DRAWING INDEX

1) ■ MWB-1 TEMPORARY MASONRY WALL BRACING PLAN

MASONRY BRACING NOTES:

A) The temporary masonry bracing design shown on these plans has been designed in accordance with the July, 2001 edition of the "Standard Practice for Bracing Masonry Walls Under Construction."

B) Strict adherence to the evacuation requirements of the restricted access zone shall be observed during construction (20 mph during the initial period, 35 mph during the intermediate period).

C) Walls designated as "Internally Braced" have been structurally analyzed to ensure that the masonry units, steel reinforcement, and foundations have sufficient strength and size. This approach complies as an alternative design per Section 1.4 of the Standard Practice.

D) Wall Material & Construction Requirements:
 -Concrete masonry units shall conform to ASTM C90.
 - $f'_i = 1000$ psi (Which corresponds to an $f'_m = 2000$ psi)
 -Type S mortar
 -Reinforcing bars shall conform to ASTM A615, Grade 60.
 -Low lift grouting
 -All steel reinforcing (including the dowels projecting from the top of the foundation) shall have minimum 48 bar diameter lap splices.

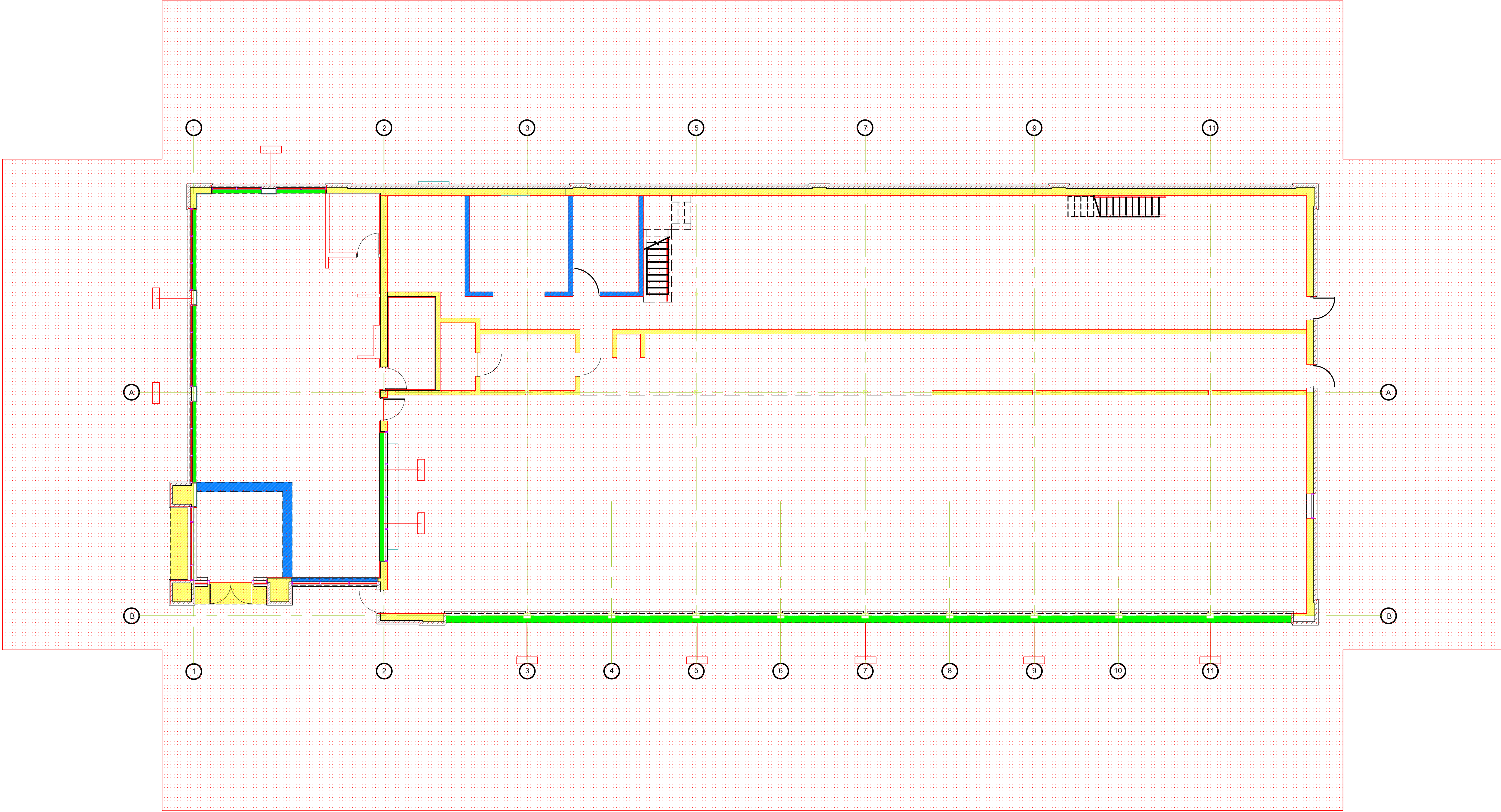

TEMPORARY MASONRY BRACING LEGEND

- RESTRICTED ZONE: EXTENDS ON EACH SIDE OF WALLS FOR A HORIZONTAL DISTANCE EQUAL TO THE CONSTRUCTED WALL HEIGHT PLUS 4'-0". ALSO CONTIGUOUS 4'-0" BEYOND THE ENDS OF THE WALLS. APPLICABLE TO ALL WALLS GREATER THAN 8' IN HEIGHT.
- INTERNALLY BRACED WALL (NO EXTERNAL BRACING REQUIRED) (SEE BRACING NOTE #1)
- INTERNALLY BRACED WALL (NO EXTERNAL BRACING REQUIRED) (SEE BRACING NOTE #1)
- EXTERNALLY BRACED WALL
- EXTERNAL BRACE

BRACING NOTES:

- 1) NO EXTERNAL BRACING REQUIRED PROVIDED WALL MEETS ANY OF THE FOLLOWING:
- A. WALL IS CONSTRUCTED CONCURRENTLY WITH INTERSECTING WALLS WITH A MAXIMUM DISTANCE BETWEEN WALLS OF 18'-0".
 - B. WALL HAS A HEIGHT $\leq 8'$ -0".
 - C. WALL HAS A HEIGHT $\leq 14'$ -8" AND THE BOTTOM PART OF THE WALL IS REINFORCED W/ #4'S @ 48" O.C. SO THAT THE MAXIMUM UNREINFORCED HEIGHT OF WALL $\leq 8'$ -0".
 - D. WALL HAS A HEIGHT $\leq 14'$ -8" AND THE BOTTOM PART OF THE WALL IS SOLID GROUTED SO THAT THE MAXIMUM UNGROUTED HEIGHT OF WALL $\leq 8'$ -0".
 - E. WALL HAS A HEIGHT $\leq 14'$ -8" AND THE WALL IS REINFORCED W/ #4'S @ 48" O.C.

FLOOR PLAN
 SCALE: 1/8" = 1'-0"

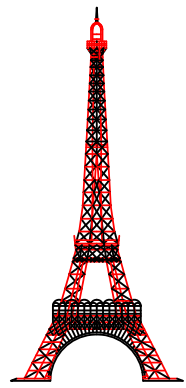

DAILEY ENGINEERING, INC.
 8485 STEPHENSON ROAD
 ONSTED, MI 49265

PH. # (517) 467-9000
 FAX # (517) 467-9010
 EMAIL - todddailey@me.com

BELLE TIRE
TEMPORARY MASONRY WALL BRACING PLAN
BELLEVILLE, MICHIGAN

DRAWN BY: M. FOWLER | CHK'D. BY: TA. DAILEY | APP'D. BY:
TEMPORARY MASONRY WALL BRACING PLAN
FLOOR PLAN

DATE: 09/24/2012 | REV.: 0 | DWG NO. **MWB-1**
 SCALE: 1/8" = 1'-0"